

ITEM#402051



Please Read Carefully
SAVE THESE INSTRUCTIONS

Thank you for purchasing a daylight24 lamp!

If you have a question about your lamp, please email us at:

info@daylight24.com

IMPORTANT SAFETY INSTRUCTIONS

INSTRUCTIONS PERTAINING TO THE RISK OF INJURY TO PERSONS:

To reduce the risk of INJURY TO PERSONS:

- 1) Turn off/unplug before cleaning or other maintenance.
- 2) Do not look directly at lighted bulb.
- 3) Keep lamp away from materials that may burn.
- 4) Please remove the batteries if not in use for long periods of time.

ASSEMBLY INSTRUCTIONS

- 1) Lay out all parts on a smooth surface as shown in illustration (as shown in FIG1).
- 2) Screw post (B) to base (A) and tighten.
- 3) Screw post (C) to post (B) and tighten.
- 4) Screw post (E) into gooseneck (D) and tighten.
- 5) Fold loose cord between post (E) and post (C) to hide inside post (C) (as shown in FIG2 step 1, 2, 3).
- 6) Screw post (E) to post (C) and tighten.
- 7) Adjust the lamp to desired height using the flexible gooseneck.

Power input:

AC adapter

- 1) Insert the male plug (G) of adapter (F) (included) into female jack of lamp (H).
- 2) Plug adapter into outlet and use the rotary dimmer switch to enjoy.

Battery operation:

- 1) Remove the cover of battery box by pushing the lip on the cover, as shown in FIG3 (right side).
- 2) Insert 4 pcs D batteries (not included) into the box, be sure the "+" and the "-" marked in the box are properly aligned with the batteries.
- 3) Close the battery box as shown FIG3 (right side).
- 4) Use the rotary dimmer switch to enjoy.

MAINTENANCE:

- 1) To clean use a soft cloth only.
- 2) Do not use any chemical or abrasive cleaners.

NOTE: This lamp uses specially formulated LEDs that simulate the characteristics of the sun. The light will appear brighter and whiter compared to a normal incandescent bulb and will provide many of the benefits of natural sunlight. In addition, these LEDs are energy

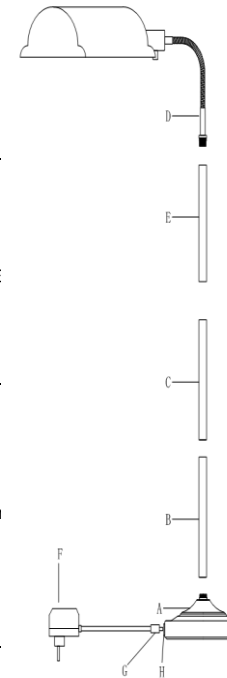
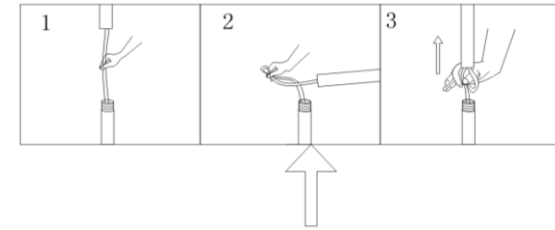

FIG1



Helpful Hint: When inserting the excess wire into the tube, using only your thumb and index finger should allow you easier access to fit the wires inside.

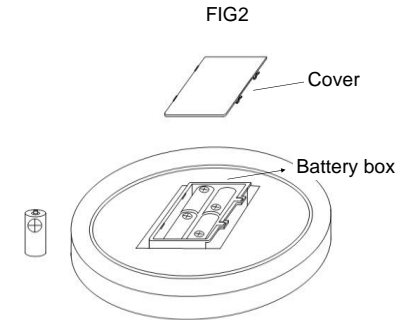

FIG3