



ITEM#402071



Please Read Carefully

SAVE THESE INSTRUCTIONS

Thank you for purchasing a daylight24 lamp!

If you have a question about your lamp, please email us at:

info@daylight24.com

IMPORTANT SAFETY INSTRUCTIONS

INSTRUCTIONS PERTAINING TO A RISK OF FIRE, ELECTRIC SHOCK OR INJURY TO PERSONS

To reduce the risk of FIRE, ELECTRIC SHOCK or INJURY TO PERSONS:

- 1) Turn off/unplug and allow to cool before cleaning or other maintenance.
- 2) Touch only switch/plug when turning on. Touch only neck when adjusting lit lamp.
- 3) Do not touch hot/warm LED at any time.
- 4) Do not look directly at lighted LED.
- 5) Keep lamp away from materials that may burn.
- 6) Do not remain in light if skin feels warm.
- 7) According to warranty rules and regulations, if the external flexible cable or cord of this luminaire is damaged, do not try to fix it. It shall be exclusively replaced by the manufacturer or his service agent or a similar qualified person in order to avoid a hazard.

ASSEMBLY INSTRUCTIONS

- 1) Lay out all parts on a smooth surface as shown in illustration.
- 2) Screw post (C) into base (B) and tighten.
- 3) Screw post (D) into post (C) and tighten.
- 4) Screw post (E) into post (D) and tighten.
- 5) Tighten the slack of the wire by pulling the excess wire from the base.
- 6) Screw part (G) into post (E) and tighten.
- 7) Connect the male/female connector (A).
- 8) Adjust the lamp to desired height using the flexible gooseneck.
- 9) Use the post toggle on/off switch to enjoy.
- 10) To change light beam width/intensity, simply move shade (I) up and down.

MAINTENANCE:

- 1) To clean use a soft cloth only.
- 2) Do not use any chemical or abrasive cleaners.

NOTE: This lamp uses specially formulated LEDs that simulate the characteristics of the sun.

The light will appear brighter and whiter compared to a normal incandescent bulb and will provide many of the benefits of natural sunlight. In addition, these LEDs are energy efficient and eco-friendly. They are not replaceable but should last up to 50,000 hours.

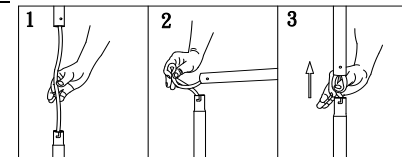
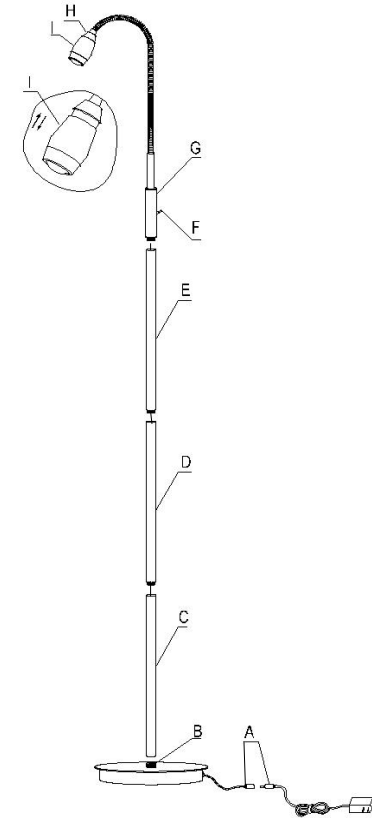

Helpful Hint: When inserting the excess wire into the tube, using only your thumb and index finger should allow you easier access to fit the wires inside.

